

# ED12 Series Rotary Encoder

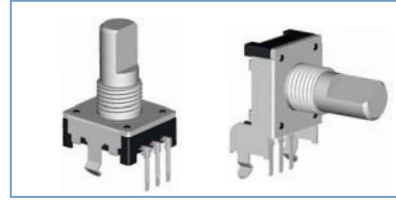

ED12 — 32 — S — 24P — 24LC — M7B5 — F15A7

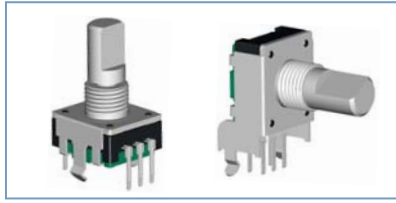
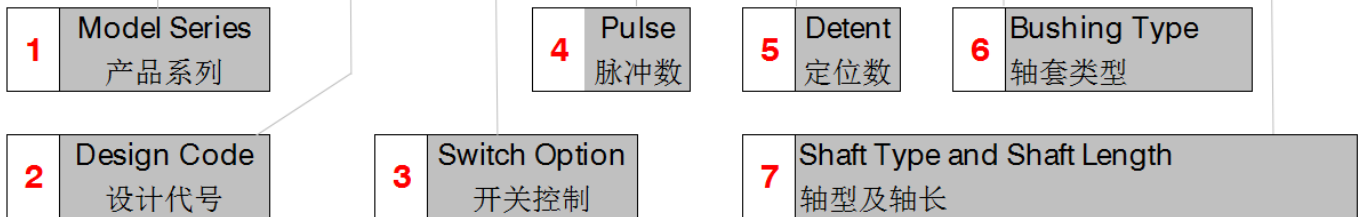

Ordering Information 订货说明		Code 代码					
<b>1</b>	Moder Series 产品系列	ED12					
<b>2</b>	Design Code 设计代号		<b>See Note 1 (ED12 Series Dimensions)</b> <b>附件 1 (ED12 系列产品图)</b>				
<b>3</b>	Switch Option 开关控制	S	With Momentary Switch 带瞬时接触开关				
			No Switch 不带开关				
<b>4</b>	Pulse 脉冲数	12P	12 脉冲				
		18P	18 脉冲				
		24P	24 脉冲				
<b>5</b>	Detent 定位数	0	12 Pulse Without Detent 12 脉冲不带定位	Code 代码	Detent torque 定位扭矩	LLC	20±10gf.cm
		12	12 Pulse With 12 Detent 12 脉冲带 12 定位				
		0	18 Pulse Without Detent 18 脉冲不带定位				
		18	18 Pulse With 18 Detent 18 脉冲带 18 定位			LC	50±20gf.cm
		0	24 Pulse Without Detent 24 脉冲不带定位			HC	90±20gf.cm
		24	24 Pulse With 24 Detent 24 脉冲带 24 定位			HHC	130±20gf.cm
<b>6</b>	Bushing Type 轴套类型	M7B5	M7 Threaded Bushing, Bushing Length 5mm / 7mm M7 螺纹, 轴套长度可选 5mm / 7mm				
		M7B7					
<b>7</b>	Shaft Type and Shaft Length 轴型及轴长	<b>See Note 2</b> <b>附表 2</b>					

## Note 2: Shaft Type and Shaft Length 轴型及轴长

### F 轴

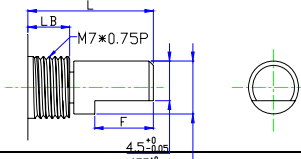

成品长	F10	F11	F12	F13	F15	F18	F20	F25	F30
LB	10	11	12	13	15	18	20	25	30
L	5	6	7	8	10	13	13	18	23
F'	4	5	5	5	7	10	10	12	12

### Y 轴

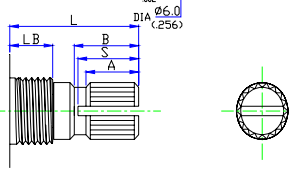

成品长	Y10	Y11	Y12	Y13	Y15	Y18	Y20	Y25	Y30
LB	5	5	5	5	5	5	7	7	7
L	10	11	12	13	15	18	20	25	30
A	4	4	5	5	7	7	7	10	10
S	3.5	4	5.5	5.5	8	8	8	11	11
B	5	6	7	6	9	9	9	12	12

### R 轴

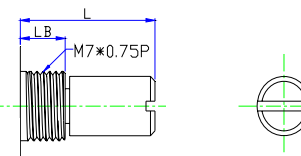

成品长	R10	R11	R12	R13	R15	R18	R20	R25	R30
LB	5	5	5	5	5	5	7	7	7
L	10	11	12	13	15	18	20	25	30

## MECHANICAL SPECIFICATION 机械性能

Operating Temperature 工作温度	-20°C ~ +70°C
Shaft Rotation Force 操作力矩	20gf.cm ~ 200gf.cm
Soldering Heat 焊接温度	260°C , 3~5sec
Push-pull Strength 轴推拉强度	10 Kgf.cm
Total Rotation Angle 全回转角度	360°

## ELECTRICAL SPECIFICATION 电气性能





Power Rating 额定功率	DC5V 10mA(Each Bit)
Output Signals 输出信号	12pulses/18pulses/24pulses, 360°
Locate Point 定位点	12detent points/18detent points/ 24detent points 360°
Phase-Difference $\Delta T$ 相位差	0.08T Min. (Measurement shall be made under the condition which the shaft is rotated in 360°/S)
Insulation resistance 绝缘电阻	More than 100M $\Omega$ (AT 50V DC)
Contact resistance 接触电阻	1 $\Omega$ Max
Withstand Voltage 耐电压	For 1 minute at 100V AC
Rotational life 回转寿命	30,000 cycles

## PUSH-ON SWITCH SPECIFICATION 推动开关

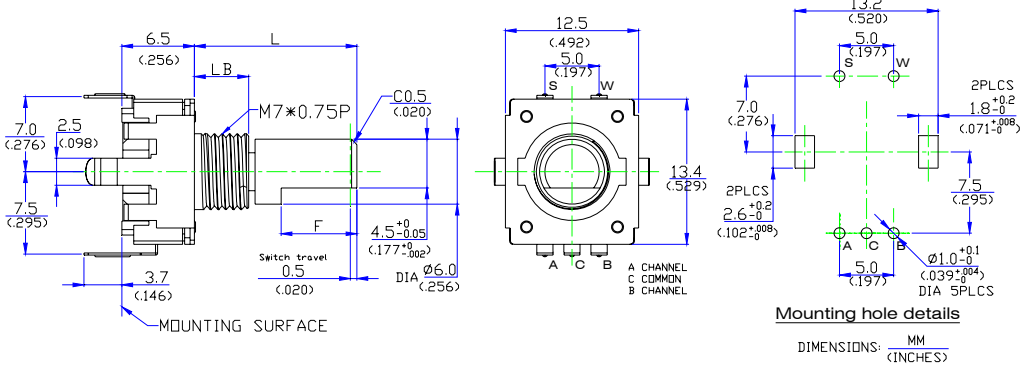
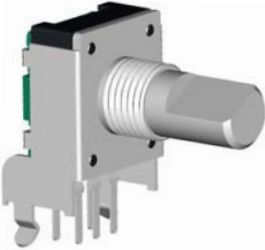
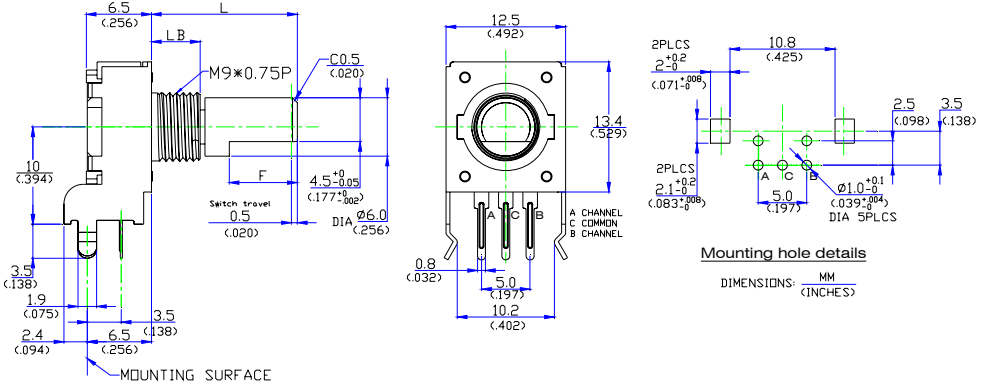

Switch Travel 开关工作行程	0.5±0.3mm
Switch Operating Force 开关作动力	610±306gf.cm
Switch Power Rating 开关额定功率	DC 12V 10mA

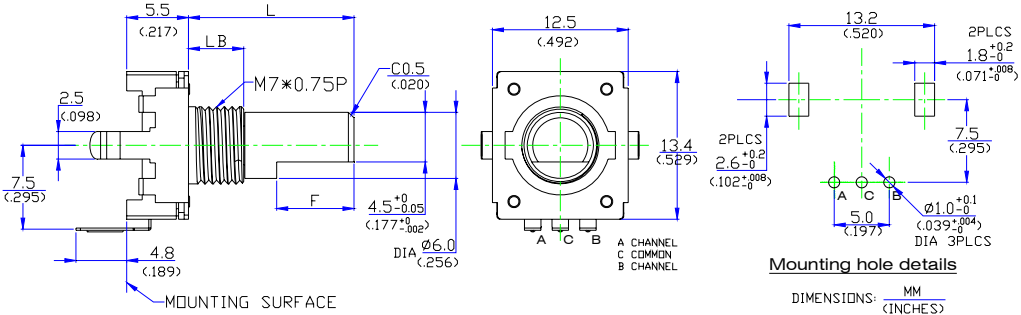
Switch Contact Resistance 开关接触阻抗	3 $\Omega$ Max
Switch Life 开关寿命	20,000 Cycles

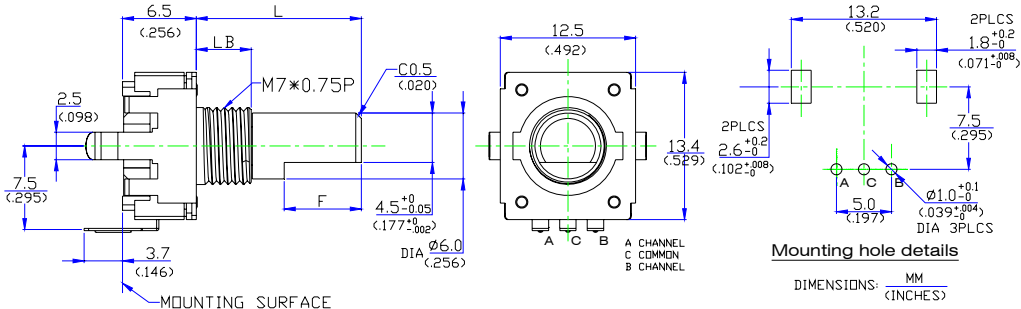
## Note 1 : ED12 Series Dimensions

<p>ED1232S-□P-□C-M7B□-□</p> 	 <p>Mounting hole details</p> <p>DIMENSIONS: MM (INCHES)</p>
<p>ED1235S-□P-□C-M7B□-□</p> 	 <p>Mounting hole details</p> <p>DIMENSIONS: MM (INCHES)</p>
<p>ED1232-□P-□C-M7B□-□</p> 	 <p>Mounting hole details</p> <p>DIMENSIONS: MM (INCHES)</p>
<p>ED1233-□P-□C-M7B□-□</p> 	 <p>Mounting hole details</p> <p>DIMENSIONS: MM (INCHES)</p>

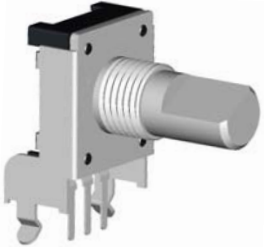
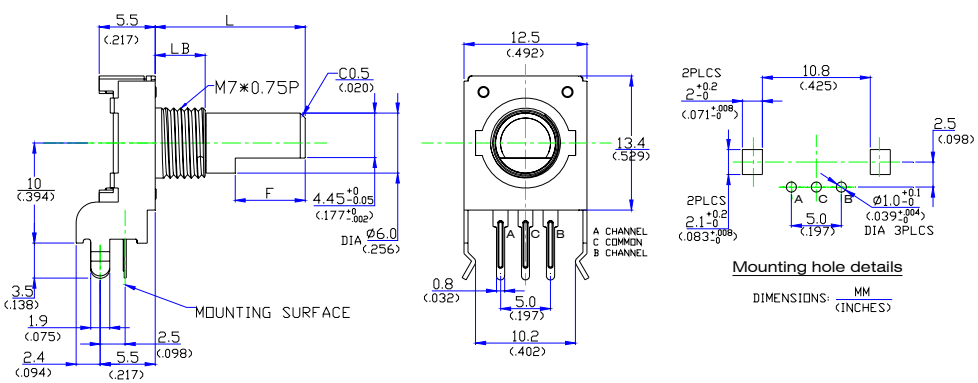
## Note 1 : ED12 Series Dimensions

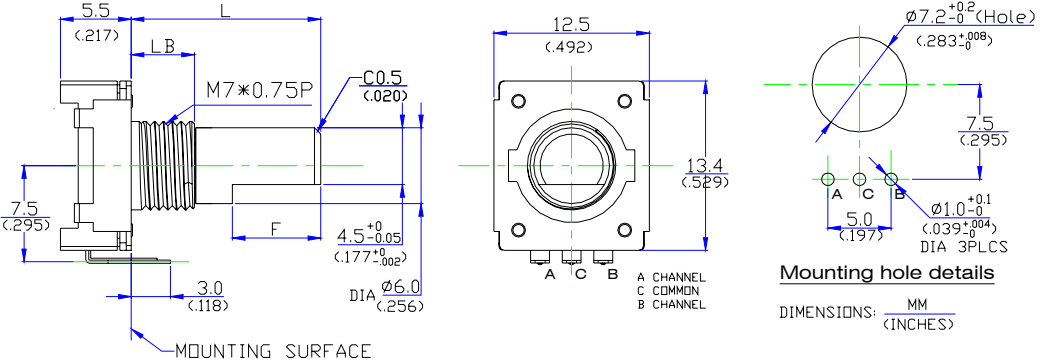
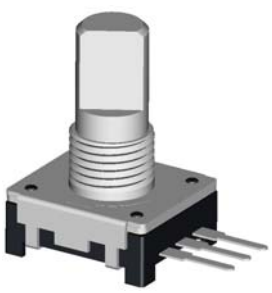
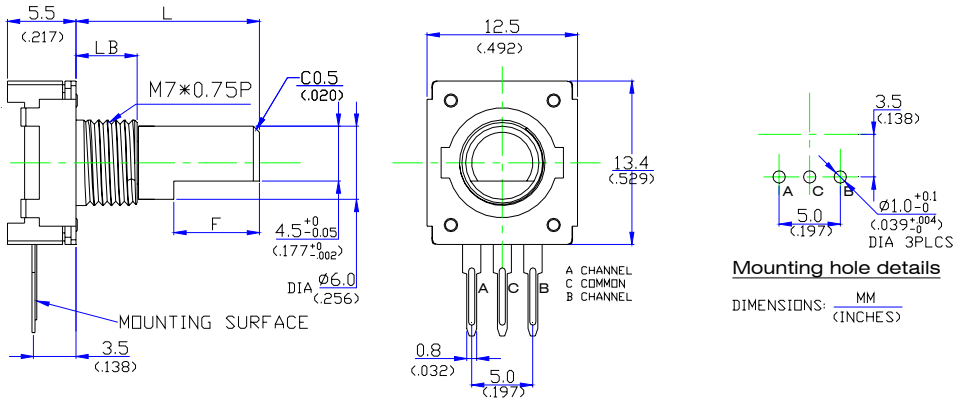
<p>ED1235-□P-□C-M7B□-□</p> 	 <p>Technical drawing of ED1235 rotary encoder showing side, front, and mounting hole details views with dimensions in mm and inches.</p>
<p>ED1253-□P-□C-M7B□-□</p> 	 <p>Technical drawing of ED1253 rotary encoder showing side, front, and mounting hole details views with dimensions in mm and inches.</p>
<p>ED1254-□P-□C-M7B□-□</p> 	 <p>Technical drawing of ED1254 rotary encoder showing side, front, and mounting hole details views with dimensions in mm and inches.</p>